

AQUALISA

COLT™ EXPOSED MIXER SHOWER

COLT001EA

WITH ADJUSTABLE HEAD

DIMENSIONAL DRAWINGS

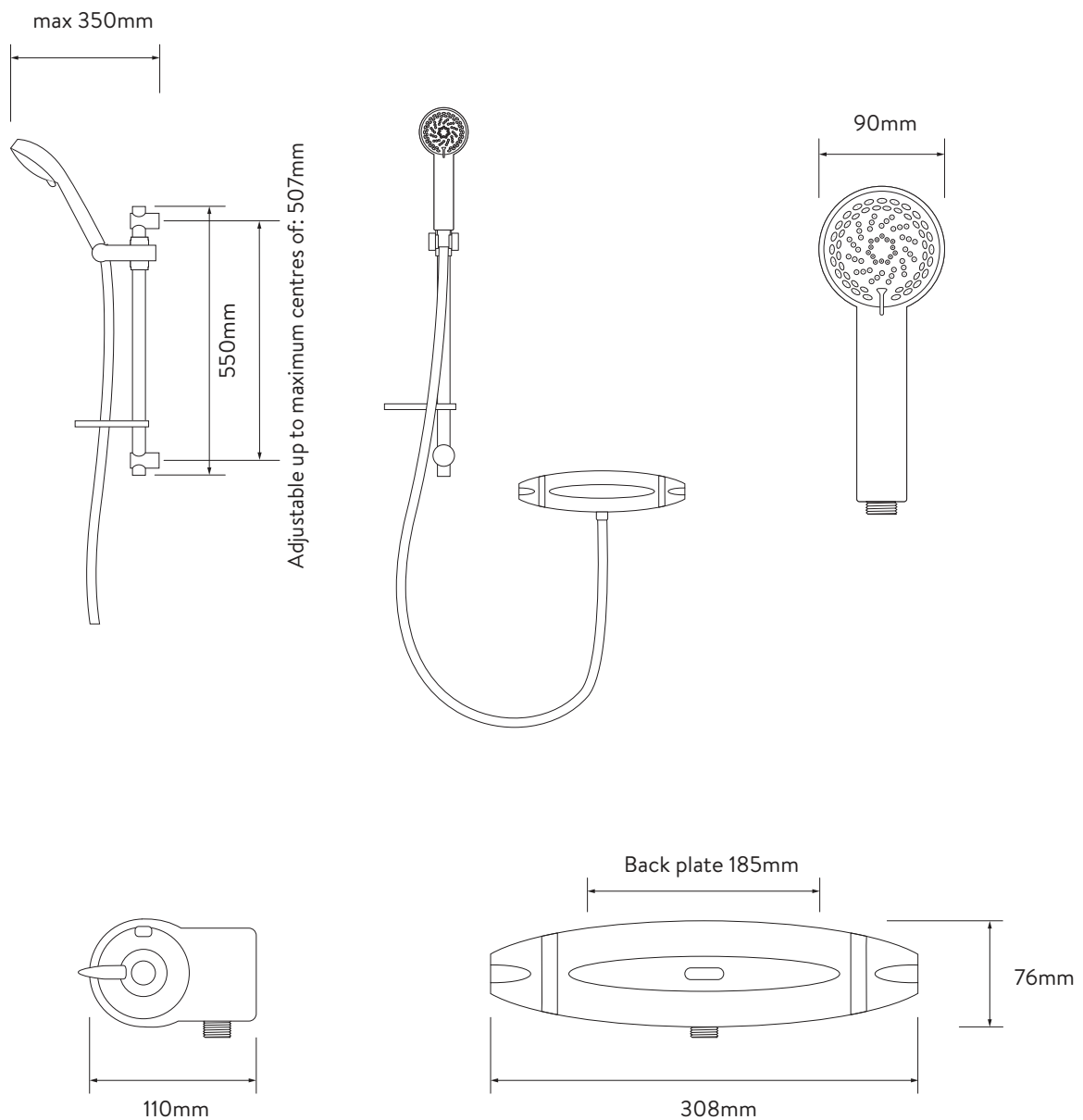

AQUALISA

COLT™ EXPOSED MIXER SHOWER

COLT001EA

WITH ADJUSTABLE HEAD

TECHNICAL SPECIFICATIONS

Minimum pressure requirements	0.1 bar
Maximum pressure requirements	10 bar
Inlet fitting connections	15mm push fit
Inlet supply positions	Hot/left, cold/right
Outlet connections	1/2" BSP
Valve inlet centres	150mm
Supply temperature	5 - 20°C Cold Supply 55 - 65°C Hot Supply
Water system	Gravity, Boosted Gravity, Combi and Balanced High Pressure
Features	Separate on/off and temperature controls
	Adjustable, 90mm Harmony shower head
	Eco-setting can deliver water savings of up to 25% without compromising on showering experience
	Temperature override button
	105mm, 4 spray patterns including an eco-setting
Colour	Chrome
Guarantee period	2 years
Approvals	CE Marking